



Fusion Camera Housing

Rugged Environmental Enclosure Series

The Fusion Camera Housing Series of environmental camera enclosures is designed to fit a multitude of rugged outdoor surveillance applications. The housing is constructed of resilient polycarbonate and has a wall / pole mount comprised of cast aluminum with a durable powder coat finish, all of which ensure protection of your camera even in the harshest of conditions. Additionally, the heavy-duty wall / pole mount keeps cables out of sight due to its feed-thru capability. This feature coupled with the side-hinged lid and tool-free camera tray ensures easy installation and servicing of your camera.

This series includes an extremely efficient climate control system where internal air is ducted throughout the housing to ensure that heat is distributed to the lens and window for removal of condensation. Also available is a Power over Ethernet (PoE) plus model with patent pending Moog Videolarm Dynamic Power Allocation (DPA) technology. PoE reduces installation time by simplifying wiring needs while DPA prioritizes power for the camera over the other less critical electronics. Perhaps most importantly, the Fusion Line is compatible with most of today's leading IP and analog camera manufacturers making it the professional's choice for environmental camera housings.

Key Features

- Meets NEMA Type 4X and IP66 standards
- IK10 impact rated
- Accommodates wide-angle lenses up to 135°
- Adjustable sunshield ("Y" models)
- Hinged wall mount allows for easy installation
- Standard wall / pole mount
- PoE or 12/24v input model
 - Supports PoE Plus IEEE802.3at compliant cameras
 - True PoE power to the camera (no splitter needed)
 - Automatically adjusts for power loss in long cable runs
 - DPA ensures maximum power to the camera



MODELS*:

FCH11CW

Environmental housing with feed-thru wall / pole mount

FCH11C2W

Environmental housing with feed-thru wall / pole mount, 24Vac or 12Vdc input, heater/ blower

FCH11C2WY

Environmental housing with feed-thru wall / pole mount, 24Vac or 12Vdc input, heater/ blower, adjustable sunshield

FCH11C8WY

Environmental housing with feed-thru wall / pole mount, DPA, PoE input, 30 watt midspan included, heater & blower, supports IEEE802.3at PoE cameras, adjustable sunshield

* For extreme heat environments see the Thermiq model FCH11Q

Easy Installation Features:

- ① Housing hinges away from mount to simplify wiring process
- ② Feed through wall / pole mount protects wiring and provides a clean appearance
- ③ Provision for conduit access through mount arm
- ④ Side housing hinge allows easy camera access

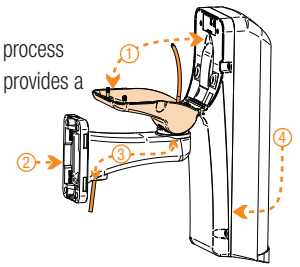

FIXED CAMERA HOUSING ACCESSORIES:

CM900

Aluminum ceiling mount bracket for PFH10/DFH10 and FCH11 series housings



SPECIFICATIONS:

General Specifications	
Camera Included:	No
Max camera length:	11" (280mm)
Mounting Style:	Wall or Pole
Size (l*w*h):	17.9" x 5.7" x 10.5" (455 x 145 x 267mm)
Weight:	4.5 lbs
Electrical Specifications	
Input Voltage:	PoE (IEEE802.3at) or 12/24v input model
Power Consumption	24Vac: 27 watts: Heater & Blower
	12Vdc: 10 watts: Heater & Blower
	PoE: 25 watts: Camera, Blower & Heater
Power Output	24/12v: Same as input, minus power for Heater & Blower
	PoE: IEEE802.3af

Mechanical Specifications	
Construction Body and Top:	Polycarbonate
Mounting Bracket Construction:	Cast aluminum
Mounting Pattern (W x H):	2" x 4.25" (51 x 108mm)
Window Construction:	Scratch resistant polycarbonate
Environmental Specifications	
Blower:	Yes (Continuous)
Effective Projected Area (EPA):	90.8 in ²
Heater activates at:	60°F (15.5°C)
Heater deactivates at:	80°F (27°C)
IP rating (Weather rating):	IP66 / NEMA 4X
Maximum Windload:	150mph (240kph)
Operating Temperature:	-50°F to 122°F (-45°C to 50°C)

Shipping Specifications

MODEL	SHIPPING WEIGHT	BOX DIMENSIONS
FCH11 Series:	6.5 lbs	8.25" x 11.75" x 19.5" (209 x 298 x 495mm)

Maximum Camera Length (MCL)

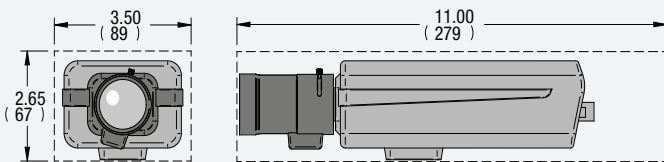

*Some cameras outside of the shown dimensions may be compatible with this housing. Contact Moog Videolarm for assistance.

Dimensions are in inches (mm)

Architectural Drawings

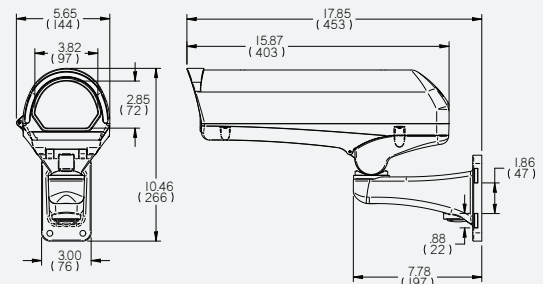

Dimensions are in inches (mm)

Regulatory & Certifications

PENDING 	PENDING 	NEMA		PENDING 		REACH
CE	CUL	NEMA Rating	RoHS	UL Listed	WEEE	REACH